



1204/22-24 Jane Bell Lane Melbourne, VIC

 1  1  1

Simply Impeccable in Every Sense

Smartly converted from a 2-bedroom apartment and fully & beautifully renovated to the highest possible standard, this light-filled over-sized one bedroom apartment owns an unrivalled central location in the most popular QV complex.

Also features timber floorboards, air-conditioning, heating and cooling, video intercom system and one security car park.

The building offers its residents great amenities including 25-meter lap pool, gymnasium and sauna on the top floor with amazing views.

With Shopping Centre simply downstairs including Big W, Woolworths, multi-level food court, and countless shops, cafe and restaurants, with walking distances to China Town, Carlton



Gerry Wang

0402 414 065

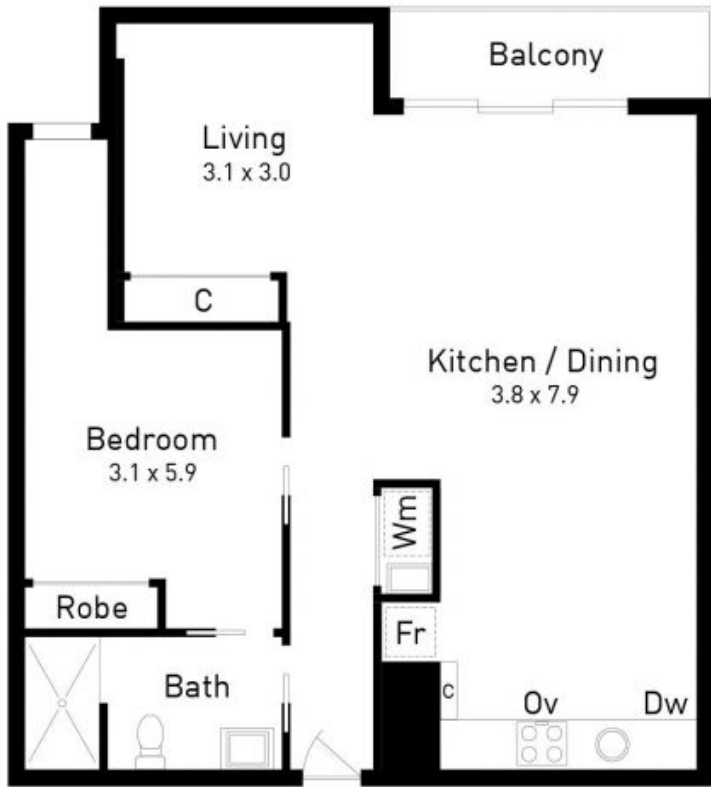

Twelfth Floor

Total Internal Area 67m²  N

1204/22-24 Jane Bell Ln, Melbourne



Disclaimer: Please note this floor plan is for marketing purposes and is to be used as a guide only. This floor plan is intended to give a general indication of the layout only. Any statements of distance, size or area are approximate and for indicative purposes only.